

KM HANDY TYPE CUTTER FOR MODELS: KSC-500, SUPRENA M700, TUFFY 503K & HERCULES

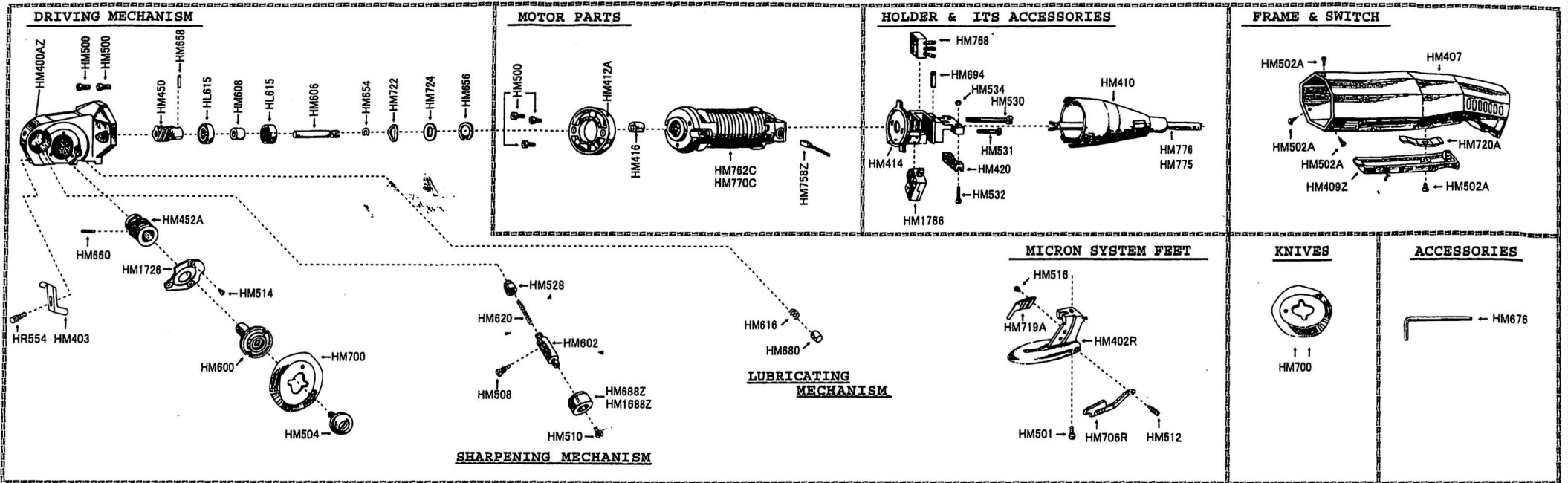

DRIVING MECHANISM

- HM400AZ..... Gear Housing
- HM450..... Worm
- HM452A..... Worm Wheel
- HM500..... Allen Screw
- HM504..... Knife Lock Screw
- HM514..... Fillister Head Screw
- HM600..... Stepped Shaft
- HM606..... Shaft
- HM608..... Spacer
- HL615..... Ball Bearing
- HM654..... E Ring
- HM656..... Snap Ring
- HM658..... Spring Pin
- HM680..... Spring Pin
- HM700..... 6-Sided Knife
- HM722..... Undulated Washer
- HM724..... Washer
- HM1726..... Cover Plate
- HM403..... Finger Guard
- HM554..... Knob Screw

SHARPENING MECHANISM

- HM508..... Stepped Screw
- HM510..... Flat Head Screw
- HM528..... Push Button
- HM602..... Stepped Shaft
- HM620..... Spring
- HM688Z..... Sharpening Stone-Medium (Standard)
- HM1688Z..... Sharpening Stone-Fine (Option)

LUBRICATING MECHANISM

- HM616..... Spring
- HM680..... Oil Pad

MOTOR PARTS

- HM412A..... Insulator
- HM416..... Coupling
- HM500..... Allen Screw
- HM758Z..... Carbon Brush Complete
- HM762C..... Motor (110V) Complete
- HM758Z..... Carbon Brush Complete
- HM770C..... Motor (220V) Complete
- HM758Z..... Carbon Brush Complete

MICRON SYSTEM FEET

- HM402R..... Base
- HM512..... Screw for Base
- HM516..... Truss Head Screw
- HM706R..... Cutting Tip (base)
- HM719A..... Spring Plate

FRAME & SWITCH

- HM407..... Frame
- HM409Z..... Switch Cover
- HM502A..... Socket Screw
- HM720A..... Spring Plate

HOLDER & ITS ACCESSORIES

- HM410..... Cord Cover
- HM414..... Holder
- HM420..... Crip
- HM530..... Flat Head Screw
- HM531..... Round Head Screw
- HM532..... Round Head Screw
- HM534..... Nut
- HM694..... Terminal
- HM776..... Cord (220V) 3 wire
- HM775..... Cord (110V) 3 pin (UL)
- HM1766..... Micro Switch
- HM788..... Coundensor

KNIVES (Standard)

- HM700..... 6-Sided Knife (Mounted with Cutter)

ACCESSORIES

- HM676..... Wrench

INSTRUCTION

The electric Mini cutter provides a most powerful and amazingly fastest cutting performance, having many distinguished features: namely, 1 Recessed sharp for total visibility, 2 Double insulated motor, 3 One-touch sharpener, 4 Carbide stationary counter cutting blade, 5 Built-in lubricator, 6 Light weight. The following are the operating instructions for your Cutter.

Start to operate:

Connect male plug to the electric power supply outlet of same voltage as shown on name plate. To operate Cutter, press switch cover (HM428A or HM409Z) and to release the switch cover, it will stop operate. The motor is double insulated (requires no grounding), therefore, it is equipped only with a 3-wire electric cord (HM774, HM775).

Cutting:

Maximum cutting height is 8mm (5/16") depending on type of materials. Lays should not be higher than its height.

Sharpening knife:

Lightly press the sharpener push button (HM528) just enough for sharpening stone (HM688Z) to grind the rotating knife. (Don't press too hard because it will burr the knife.) You should keep knife always sharp for clean and accurate cutting.

Lubrication:

- (a) Felt oiler (HM680) behind knife - Requires oil only when cutting plastics or the materials which is apt to adhere to knife.
- (b) Gears (HM450 & HM452A) - In case Cutter uses daily, grease gears each week with grease through bushing located in back of gear housing (HM400Z)
- (c) Motor ball bearings (HM615) - Grease every 12 months in case Cutter is in regular use. Remove old grease with cleaning fluid.

Change knife:

Insert 3mm Pin into hole in knife. Unscrew knife lock screw (HM504) with coin. Tip over Cutter and push out the knife with finger.

Replace the worn knife and also the counter cutting blade (HM729A), if necessary. Lock knife with knife lock screw and rest the oscillating oiler. To obtain clean cutting, requires counter cutting blade set at angle of 10° against to the knife - to brush only the edge of the knife. When knife is worn down to about (42mm) (1-5/8"), it must be replaced.

Change sharpening stone:

Remove the knife, then loose stepped screw (HM508) to take out sharpening mechanism. Remove sharpening stone (HM688Z) from stepped shaft (HM602) by unscrewing flat head screw (HM510) and put in new sharpening stone. Remove compression spring (HM620) by unscrewing push button (HM528) on stepped shaft. Replace sharpening mechanism into gear housing (HM400AZ), insert stepped screw through gear housing and into stepped shaft. Then replace compression spring and push button. To clean sharpening stone, simply use cleaning fluid and a brush to keep it clean.

Change carbon brushes:

Check carbon brushes (HM758Z) every 200 hours of use. Using Screw driver remove the three screws (HM502A) from the frame (HM408 or HM407). Slide off the frame. Then remove the screw from the exposed motor and replace the old carbon brushes with new ones.

Cutting base:

- (a) For Synchro system cutting base Unscrew (HM548) and remove the Base plate (HM428A). Then the Cutting foot (HM424) with counter blade (HM550, HM728 & 729A) will handle the different type of materials.
- (b) For Micron system cutting feet Remove the base (HM402R) by removing flat head screw (HM501) that looks the base in place. Pull the base downward and off the pin.

KM HANDY TYPE CUTTER FOR MODELS: KSC-500, SUPRENA M700, TUFFY 503K & HERCULES

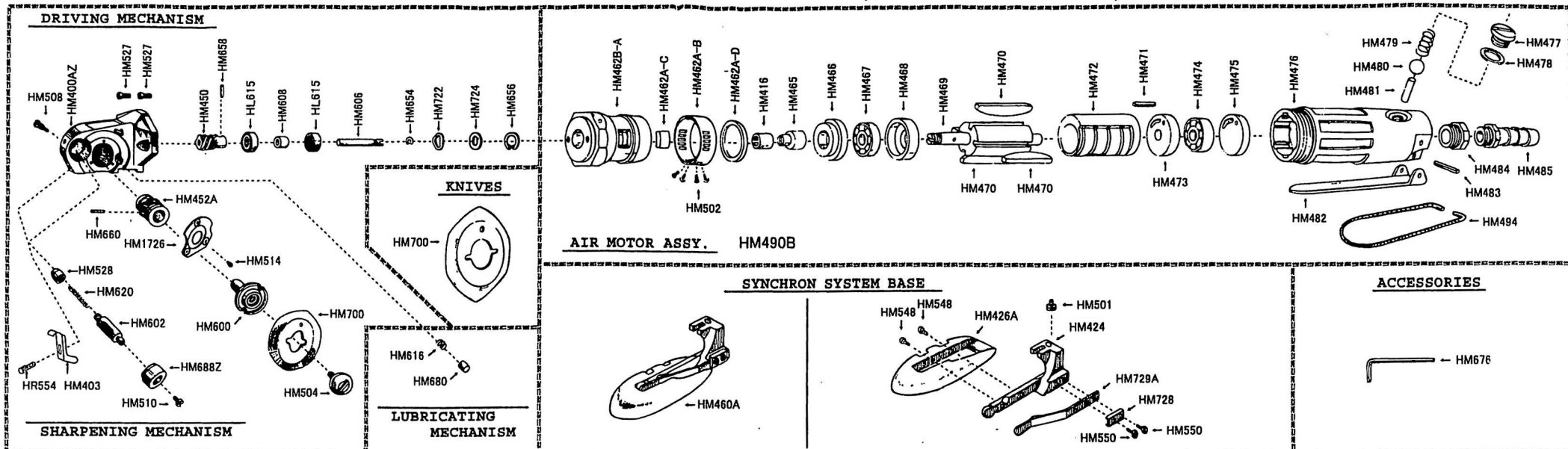

DRIVING MECHANISM

HM400AZ.....Gear Housing
 HM450.....Worm
 HM452A.....Worm Wheel
 HM527.....Allen Screw
 HM504.....Knife Lock Screw
 HM508.....Stepped Screw
 HM514.....Fillster Head Screw
 HM600.....Stepped Shaft
 HM606.....Shatt
 HM608.....Spacer
 HL615.....Ball Bearing
 HM654.....E Ring
 HM656.....Snap Ring
 HM658.....Spring Pin
 HM660.....Spring Pin
 HM700.....6-Sided Knife
 HM722.....Undulated Washer
 HM724.....Washer
 HM1726.....Cover Plate Complete
 HM440A.....Worm Wheel Assy.
 HM403.....Finger Guard
 HR554.....Knob Screw

SHARPENING MECHANISM

HM510.....Flat Head Screw
 HM528.....Push Button
 HM602.....Stepped Shaft

HM620.....Spring
 HM688Z.....Sharpening Stone Complete
 HM444.....Sharpener Assy.

KNIVES

HM700.....6-Sided Knife

AIR MOTOR ASSY.

HM462B-A.....Connector
 HM462A-B.....Silencer
 HM462A-C.....Filter C
 HM462A-D.....Filter D
 HM416.....Coupling
 HM465.....Nut
 HM466.....Guide Plate
 HM467.....Ball Bearing
 HM468.....Front Bracket
 HM469.....Rotor
 HM470.....Vane
 HM471.....Spring Pin
 HM472.....Cylinder
 HM473.....Rear Bracket
 HM474.....Ball Bearing
 HM475.....End Plate
 HM476.....Motor Case
 HM477.....Valve Screw
 HM478.....Packing
 HM479.....Spring

HM480.....Ball
 HM481.....Valve Pin
 HM482.....Throttle Lever
 HM483.....Spring Pin
 HM484.....Air Inlet Joint (P.T.1/4)
 HM485.....Air Inlet
 HM494.....Hanger Hook
 HM490B.....Air motor assy.
 HM502.....Socket Screw

LUBRICATING MECHANISM

HM616.....Spring
 HM680.....Oil Pad

SYNCHRON SYSTEM BASE

HM424.....Cutting Foot
 HM426A.....Base Plate
 HM501.....Flat Head Screw
 HM548.....Round Head Screw
 HM550.....Flat Head Screw
 HM728.....Plate
 HM729A.....Counter Blade Complete
 HM460A.....Synchron base assy.

ACCESSORIES

HM676.....Wrench

INSTRUCTION

The electric Mini cutter provides a most powerful and amazingly fastest cutting performance, having many distinguished features; namely, 1 Recessed sharp for total visibility, 2 Double insulated motor, 3 One-touch sharpener, 4 Carbide stationary counter cutting blade, 5 Built-in lubricator, 6 Light weight. The following are the operating instructions for your Cutter.

Start to operate:

Connect male plug to the electric power supply outlet of same voltage as shown on name plate. To operate Cutter, press switch cover (HM429A or HM409Z) and to release the switch cover, it will stop operate. The motor is double insulated (requires no grounding), therefore, it is equipped only with a 3-wire electric cord (HM774, HM775).

Cutting:

Maximum cutting height is 8mm (5/16") depending on type of materials. Lays should not be higher than its height.

Sharpening knife:

Lightly press the sharpener push button (HM528) just enough for sharpening stone (HM688Z) to grind the rotating knife. (Don't press too hard because it will burr the knife.) You should keep knife always sharp for clean and accurate cutting.

Lubrication:

- Felt oiler (HM680) behind knife - Requires oil only when cutting plastics or the materials which is apt to adhere to knife.
- Gears (HM450 & HM452A) - In case Cutter uses daily, grease gears each week with grease through bushing located in back of gear housing (HM400Z)
- Motor ball bearings (HM615) - Grease every 12 months in case Cutter is in regular use. Remove old grease with cleaning fluid.

Change knife:

Insert 3mm Pin into hole in knife. Unscrew knife lock screw (HM504) with coin. Tip over Cutter and push out the knife with finger.

Replace the worn knife and also the counter cutting blade (HM729A), if necessary. Lock knife with knife lock screw and rest the oscillating oiler. To obtain clean cutting, requires counter cutting blade set at angle of 10° against to the knife - to brush only the edge of the knife. When knife is worn down to about (42mm) (1-5/8"), it must be replaced.

Change sharpening stone:

Remove the knife, then loose stepped screw (HM508) to take out sharpening mechanism. Remove sharpening stone (HM688Z) from stepped shaft (HM602) by unscrewing flat head screw (HM510) and put in new sharpening stone. Remove compression spring (HM620) by unscrewing push button (HM528) on stepped shaft. Replace sharpening mechanism into gear housing (HM400AZ), insert stepped screw through gear housing and into stepped shaft. Then replace compression spring and push button. To clean sharpening stone, simply use cleaning fluid and a brush to keep it clean.

Change carbon brushes:

Check carbon brushes (HM758Z) every 200 hours of use. Using Screw driver remove the three screws (HM502A) from the frame (HM406 or HM407). Slide off the frame. Then remove the screw from the exposed motor and replace the old carbon brushes with new ones.

Cutting base:

- For Synchron system cutting base Unscrew (HM548) and remove the Base plate (HM426A). Then the Cutting foot (HM424) with counter blade (HM550, HM728 & 729A) will handle the different type of materials.
- For Micron system cutting feet Remove the base (HM402R) by removing flat head screw (HM501) that locks the base in place. Pull the base downward and off the pin.